

ORDERING CODE - S6D SERIES

S6D * - B38 - 1 R 00 - S 1

Series _____

Y- Metric port connection
Omit for UNC

Cam ring _____

Volumetric displacement cm³/rev (in³/rev)

B14 = 47.6 (2.90)	B35 = 111.0 (6.77)
B17 = 58.2(3.55)	B38 = 120.3 (7.34)
B20 = 66.0 (4.03)	B42 = 136.0 (8.30)
B24 = 79.5 (4.85)	B45 = 145.7 (8.89)
B28 = 89.7 (5.47)	B50 = 158.0 (9.64)
B31 = 98.3 (6.00)	B61 = 190.5 (11.62)

Type of shaft _____

1 - keyed (SAE C)
2 - keyed (no SAE)
3 - splined (SAE C)
4 - splined (no SAE)

Seal class
1 - S1 (for mineral oil)
4 - S4 (for fire resistant fluids)
5 - S5 (for mineral oil and fire resistant fluids)

Design letter _____

Porting combination
00 - standard

00



01



02



03

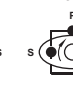

S - Suction port **P** - Pressure port

Direction of rotation (view on shaft end)
R - clockwise
L - counter-clockwise

OPERATING CHARACTERISTICS - TYPICAL (24 cST)

Pressure port	Series	Volumetric Displacement Vp		Flow q & n = 1500 rpm						Input power p & n = 1500 rpm					
				p = 0 bar (0 psi)		p = 140 bar (2000 psi)		p = 240 bar (3500 psi)		p = 7 bar (100 psi)		p = 140 bar (2000 psi)		p = 240 bar (3500 psi)	
		in ³ /rev	cm ³ /rev	gpm	lpm	gpm	lpm	gpm	lpm	hp	kw	hp	kw	hp	kw
S6D	B14	2.90	47.6	18.88	71.4	16.42	62.1	14.78	55.9	3.08	2.3	24.81	18.5	41.03	30.6
	B17	3.55	58.2	23.1	87.3	20.6	78.0	18.99	71.8	3.35	2.5	29.77	22.2	49.62	37.0
	B20	4.00	66.0	26.19	99.0	23.73	89.7	22.08	83.5	3.75	2.8	33.39	24.9	55.92	41.7
	B24	4.80	79.5	31.56	119.3	29.10	110.0	27.46	103.8	4.02	3.0	39.69	29.6	66.78	49.8
	B28	5.50	89.7	35.58	134.5	33.12	125.2	31.48	119.0	4.29	3.2	44.52	33.2	74.96	55.9
	B31	6.00	98.3	39.00	147.5	36.53	138.1	34.89	131.9	4.42	3.3	48.54	36.2	81.80	61.0
	B35	6.80	111.0	44.04	166.5	41.58	157.2	39.94	151.0	4.69	3.5	54.58	40.7	92.13	68.7
	B38	7.30	120.3	47.72	180.4	45.26	171.1	43.62	164.9	4.96	3.7	58.87	43.9	99.64	74.3
	B42 ¹⁾	8.30	136.0	53.96	204.0	51.50	194.7	49.86	188.5	5.36	4.0	66.25	49.4	112.24	83.7
	B45 ¹⁾	8.89	145.7	57.80	218.5	55.34	209.2	53.70	203.0	5.50	4.1	70.81	52.8	120.02	89.5
	B50 ^{1,2)}	9.64	158.0	62.69	237.0	60.23	227.7	59.25	224.0	5.90	4.4	76.44	57.0	113.98	85.0
	B61 ^{1,3)}	11.62	190.5	76.25	285.7	73.54	278.0	--	--	6.16	4.6	81.26	60.6	--	--

1) 042-045-050-061=2200 RPM max.

2) 050=210 bar (3000 psi) max. int.

3) 061 = 120 bar (1740 psi) max. int, 061 = 80 bar (1160 psi) cont.

B14-B38 Peak Pressure 270 bar

DIMENSIONS - S6D SERIES

WEIGHT : 24.1 Kg.

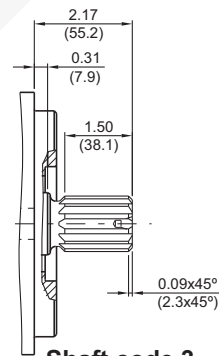
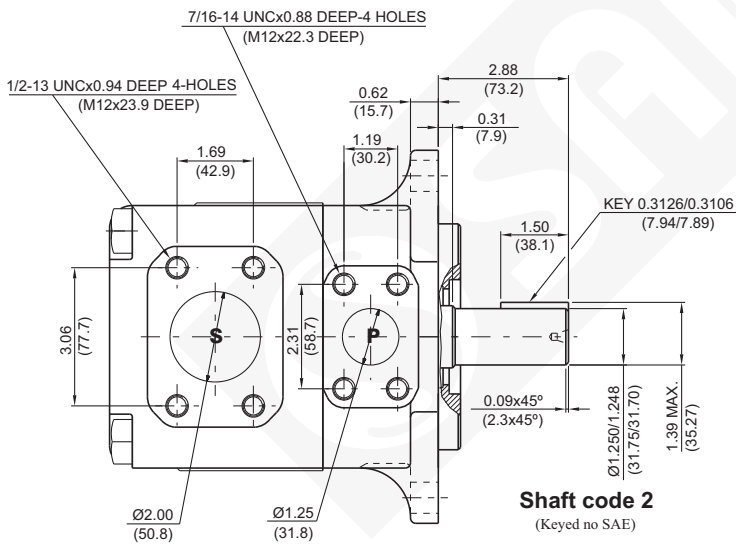
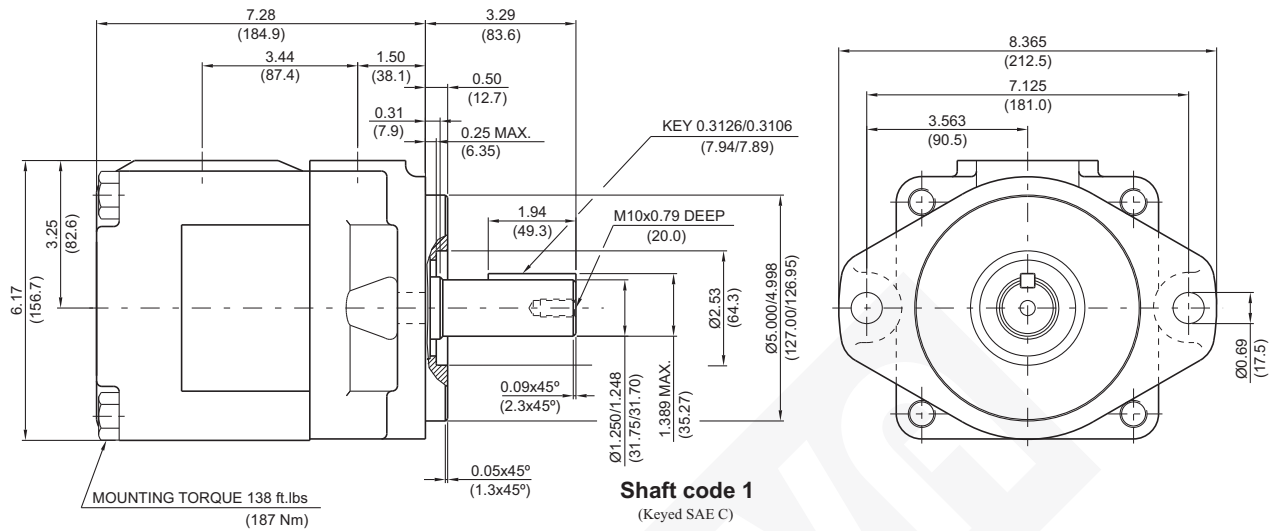

Shaft code 3
SAE C splined shaft
Class 1-J498b
12/24 dp. 14 teeth
30° pressure angle
flat root side fit

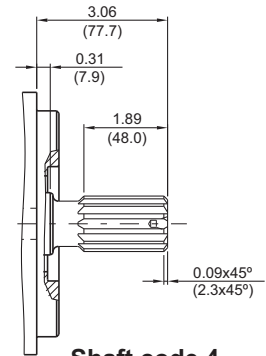

Shaft code 4
no SAE splined shaft
Class 1-J498b
12/24 dp. 14 teeth
30° pressure angle
flat root side fit

Shaft torque limits in ³ /rev x psi (ml/rev x bar)	
Shaft	Vp x p max.
1	38299 (43283)
2	30638 (34590)
3	54207 (61200)
4	54207 (61200)